

## Floor Plan of the Barrons' Electronic Music Studio in 1956

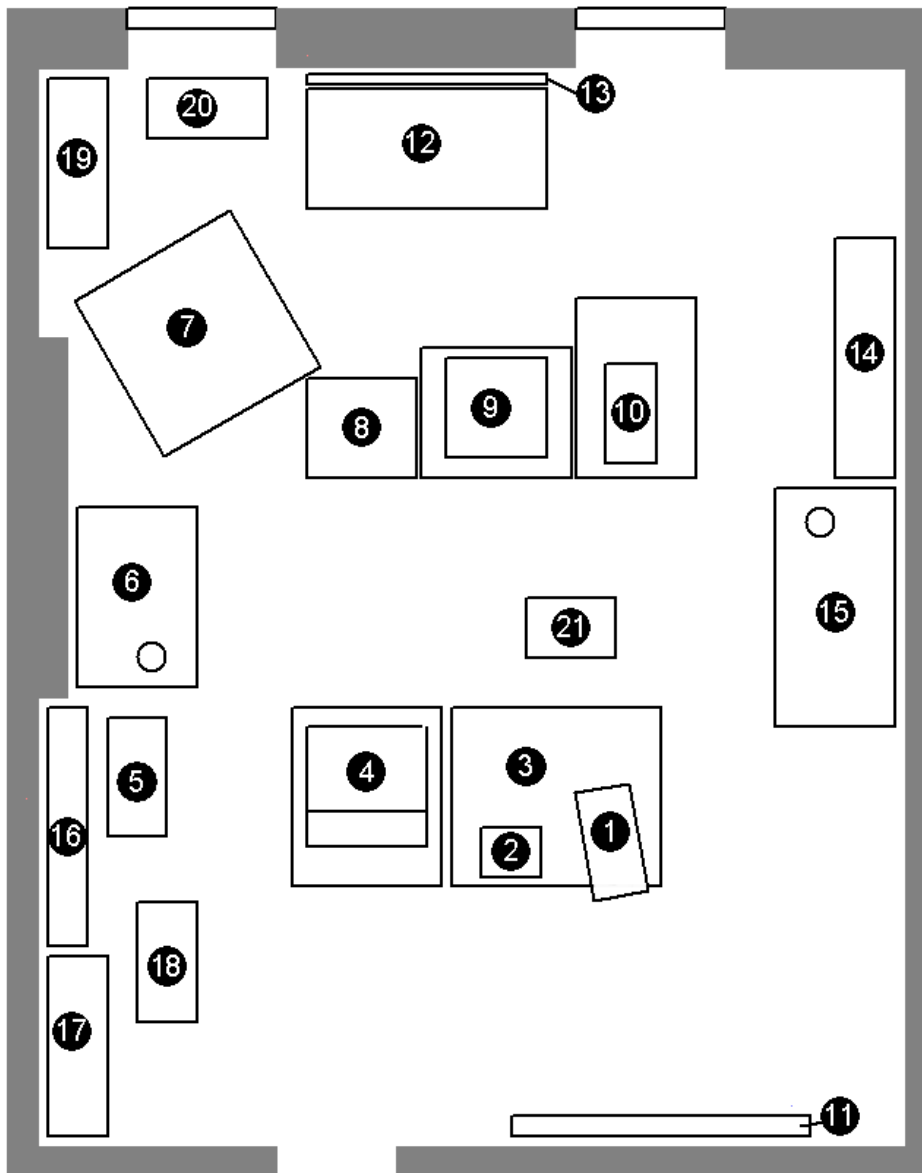

1. *Precise Development Corporation* 300 B oscilloscope
2. Signal Generator
3. Louis's soldering/test bench
4. *RCA* Tube mixer
5. *Stancil-Hoffman* ¼" reel-to-reel tape machine
6. Reel-to-reel tape machine and Bebe's splicing bench
7. 12" speaker mounted in infinite baffle enclosure
8. 19" rack containing tube oscillators, amplifiers and reverb
9. Plate reverb
10. 16mm *Ampro* 20 projector
11. Projector screen
12. Metal-working bench
13. Tool rack
14. Shelf of tape reels, books and magazines
15. Desk
16. Shelf of tape reels and 16mm film cans
17. Shelf of components and supplies
18. Rack of amplifiers and supplies and consumables
19. Shelves
20. Shelves
21. Television tray table

Drawn by Phil Taylor  
phil@effectrode.com